

Door blank with Compact Laminate - 110 mm stiles and rails

Construction:

4 mm Compact laminate	(Appr. 1350 kg/m ³ - heat conductivity: 0,25 W/mK)
1,5 mm long grain veneer	
0,3 mm Aluminium - moisture barrier - stabilizer	
1,5 mm long grain inner veneer	
Insulation - Polystyrene	(Appr. 20 kg/m ³ - heat conductivity: 0,034 W/mK)
1,5 mm long grain inner veneer	
0,3 mm Aluminium - moisture barrier - stabilizer	
1,5 mm long grain veneer	
4 mm Compact laminate	(Appr. 1350 kg/m ³ - heat conductivity: 0,25 W/mK)

U-Value:

U-Value - W/m ² K									
60 mm	68 mm	73 mm	80 mm						
0,93	0,85	0,79	0,74						

Size 1000 mm x 2000 mm
 Heat conductivity is calculated on the basis of the practical heat conductivity of each included material - taken from data sheets and DS418, version 6, 2002. Also relating to EN 12524.

Weight:

Weight appr. Kg./m ²									
60 mm	68 mm	73 mm	80 mm						
23,0	24,3	25,1	26,3						

Size 1000 mm x 2000 mm

Measure:

Min.: 250 x 450 mm - Max.: 1200 x 2400 mm

Tolerances:

Width/Height: +/- 1 mm - Diagonal: +/- 2 mm - Thickness: +/- 0,8 mm

Section drawing:

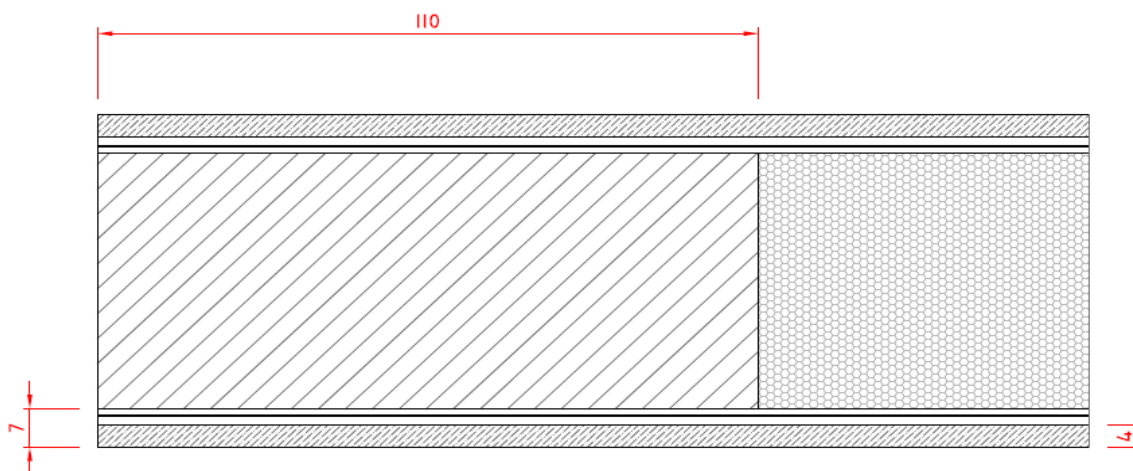

O.H.Industri A/S
 Smedevej 17
 DK - 7430 Ikast
 +45 9725 1200
www.ohindustri.com

Made: 05.03.14	Data sheet: PMN	Draw.: HMN
Revised: 28.08.14	Data sheet: PMN	Draw.: