

Panels Aluminium/Chen-Chen-W.0,3 mm Aluminium

Construction: 1,5 mm Aluminium (EN AW-1050A-GSB approved powder coating of aluminium surface)
 Insulation - Polystyrene (Appr. 33 kg/m³ - heat conductivity: 0,034 W/mK)
 1,5 mm long grain inner veneer
 0,3 mm Aluminium - moisture barrier - stabilizer
 1,5 mm long grain veneer
 1,5 mm cross grain veneer
 1,5 mm Chen-Chen veneer

U-Value:	U-Value - W/m ² K						
	24	26	28	32	36	40	48
Thickness (mm)							
U-Value	1,39	1,29	1,20	1,05	0,93	0,84	0,70

Heat conductivity is calculated on the basis of the practical heat conductivity of each included material - taken from data sheets and DS418, version 6, 2002. Also relating to EN 12524.

Weight:	Weight appr. Kg./m ²						
	24	26	28	32	36	40	48
Thickness (mm)							
Weight	8,4	8,5	8,5	8,7	8,8	8,9	9,2

Measure: Min.: 250 x 250 mm - Max.: 1200 x 2400 mm / 2400 x 1200 mm

Tolerances: Width/Height: +/- 1 mm - Diagonal: +/- 2 mm - Thickness: +/- 0,8 mm

Section drawing:

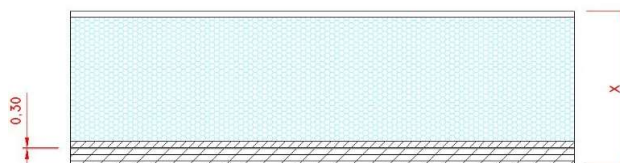

Made: 14.06.2016	Data sheet: CRS	Draw.: CRS
Revised:	Data sheet:	Draw.:

O.H.Industri A/S
 Smedevej 17
 DK - 7430 Ikast
 +45 9725 1200
www.ohindustri.com