

Sound absorbing panels - Sound insulation value 39 dB

Panels HDF/HDF

Construction:	4 mm HDF	(Appr.970 kg/m ³ - heat conductivity: 0,13 W/mK)
	Insulation - Polystyrene	(Appr. 33 kg/m ³ - heat conductivity: 0,035 W/mK)
	9 mm Bitumen (BF43)	(Appr. 1850 kg/m ³ - heat conductivity:Not included)
	Insulation - Polystyrene	(Appr. 33 kg/m ³ - heat conductivity: 0,035 W/mK)
	4 mm HDF	(Appr.970 kg/m ³ - heat conductivity: 0,13 W/mK)

U-Value:

U-Value - W/m ² K									
32 mm	43 mm	48 mm	52 mm	54 mm					
1,49	1,00	0,87	0,79	0,76					

Heat conductivity is calculated on the basis of the practical heat conductivity of each included material - taken from data sheets and DS418, version 6, 2002. Also relating to EN 12524.

Weight:

Weight appr. Kg./m ²									
32 mm	43 mm	48 mm	52 mm	54 mm					
24,9	25,3	25,4	25,6	25,6					

Sound reduction:

Weighted sound reduction - R _w (C; C _{tr})= 39 (-1; -4) dB									
All thicknesses									
39									

Measure:

Min.: 120 x 250 mm - Max.: 1200 x 2400 mm

Tolerances:

Width/Height: +/- 1 mm - Diagonal: +/- 1,5 mm - Thickness: +/- 0,8 mm

Section drawing:

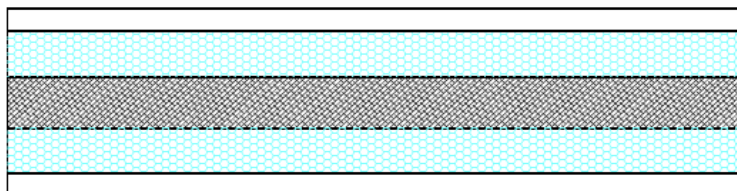

Made: 02.02.16	Data sheet: PMN	Draw.: HMN
Revised: 29.03.16	Data sheet: PMN	Draw.:

O.H.Industri A/S
Smedevej 17
DK - 7430 Ikast
+45 9725 1200
www.ohindustri.com