

Sounds absorbing panels - Sound insulation value 35 dB

Panels HDF/HDF

| | | |
|----------------------|--------------------------|--|
| Construction: | 4 mm HDF | (Appr.970 kg/m ³ - heat conductivity: 0,13 W/mK) |
| | Insulation - Polystyrene | (Appr. 33 kg/m ³ - heat conductivity: 0,035 W/mK) |
| | 4,5 mm Bitumen (BF43) | (Appr. 1850 kg/m ³ - heat conductivity:Not included) |
| | Insulation - Polystyrene | (Appr. 33 kg/m ³ - heat conductivity: 0,035 W/mK) |
| | 4 mm HDF | (Appr.970 kg/m ³ - heat conductivity: 0,13 W/mK) |

U-Value:

| U-Value - W/m ² K | | | | | | | | | |
|------------------------------|-------|-------|-------|-------|--|--|--|--|--|
| 32 mm | 43 mm | 48 mm | 52 mm | 54 mm | | | | | |
| 1,22 | 0,87 | 0,77 | 0,71 | 0,68 | | | | | |

Heat conductivity is calculated on the basis of the practical heat conductivity of each included material - taken from data sheets and DS418, version 6, 2002. Also relating to EN 12524.

Weight:

| Weight appr. Kg./m ² | | | | | | | | | |
|---------------------------------|-------|-------|-------|-------|--|--|--|--|--|
| 32 mm | 43 mm | 48 mm | 52 mm | 54 mm | | | | | |
| 16,7 | 17,1 | 17,3 | 17,4 | 17,5 | | | | | |

Sound reduction:

| Weighted sound reduction - R _w (C; C _{tr})= 35 (-1; -4) dB | | | | | | | | | |
|---|--|--|--|--|--|--|--|--|--|
| All thicknesses | | | | | | | | | |
| 35 | | | | | | | | | |

Measure:

Min.: 120 x 250 mm - Max.: 1200 x 2400 mm

Tolerances:

Width/Height: +/- 1 mm - Diagonal: +/- 1,5 mm - Thickness: +/- 0,8 mm

Section drawing:

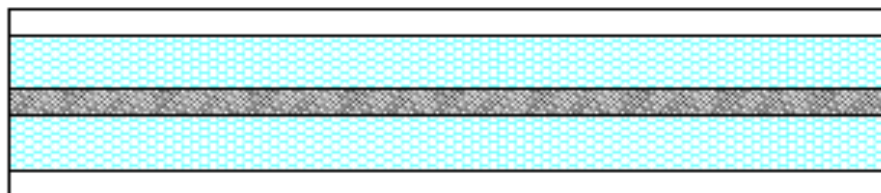

| | | |
|-------------------|-----------------|------------|
| Made: 01.03.16 | Data sheet: PMN | Draw.: HMN |
| Revised: 29.03.16 | Data sheet: PMN | Draw.: |

O.H.Industri A/S
Smedevej 17
DK - 7430 Ikast
+45 9725 1200
www.ohindustri.com