

## Panels raised and fielded - 15 mm Pine

**Construction:** 15 mm Laminated pine ( Appr. 500 kg/m<sup>3</sup> - heat conductivity: 0,13 W/mK )  
 Glued with waterproof adhesive  
 Insolation - Polystyrene ( Appr. 33 kg/m<sup>3</sup> - heat conductivity: 0,034 W/mK )  
 15 mm Laminated pine ( Appr. 500 kg/m<sup>3</sup> - heat conductivity: 0,13 W/mK )  
 Glued with waterproof adhesive

**U-Value:**

U-Value - W/m <sup>2</sup> K									
23 mm	24 mm	26 mm							
1,23	1,19	1,11							

Measure specified as rebate measure.  
 Heat conductivity is calculated on the basis of the practical heat conductivity of each included material - taken from data sheets and DS418, version 6, 2002. Also relating to EN 12524.

**Weight:**

Weight appr. Kg./m <sup>2</sup>									
23 mm	24 mm	26 mm							
15,5	15,5	15,6							

Measure specified as rebate measure.

**Measure:** Min.: 150 x 250 mm - Max.: 1030 x 2300 mm  
 No warranty on panels larger than 400 mm in the width

**Tolerances:** Width/Height: +/- 1 mm - Diagonal: +/- 1,5 mm - Thickness: +/- 0,8 mm

**Section drawing:**

Profile type 1

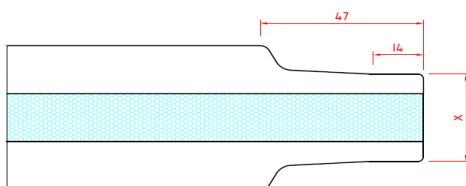

Profile type 2

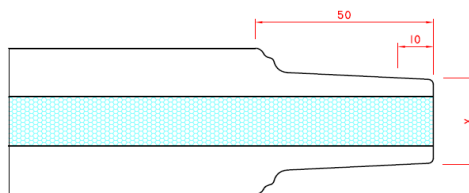

Profile type 3

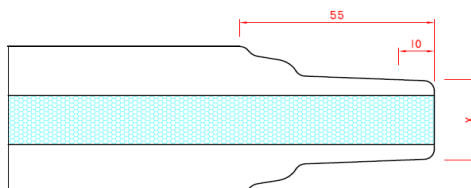

Profile type 4

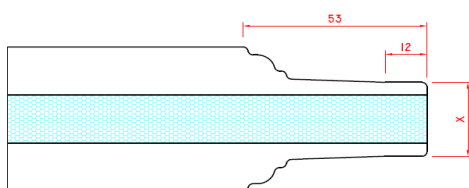

Made: 15.05.14	Data sheet: PMN	Draw.: HMN
Revised:	Data sheet:	Draw.: