

Standard Grooves doors

Type 20 (12 x 3 mm)
4 layers of veneer

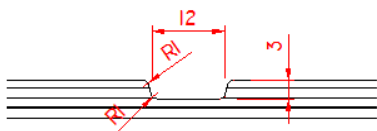

Type 20 (12 x 2,2 mm) - (12 x 1,5 mm)
HDF and HPL

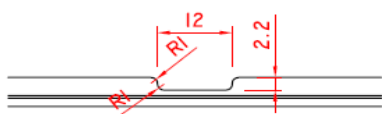

Type 40 (6 x 3,0 mm)
4 layers of veneer

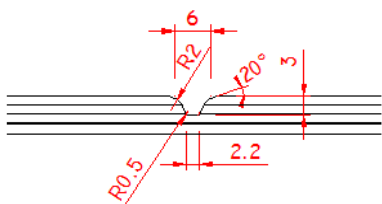

Type 50 (28 x 2,2 mm) - (12 x 1,5 mm)
HDF (2,2 mm) and HPL (1,5 mm)

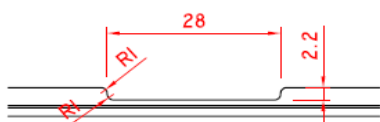

Type 50 (28 x 3 mm)
4 layers of veneer

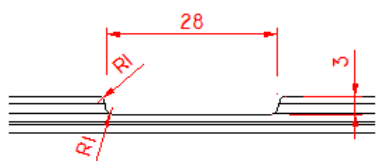

Standard Grooves panels

Type 20 (12 x 0,5 mm)
Aluminium

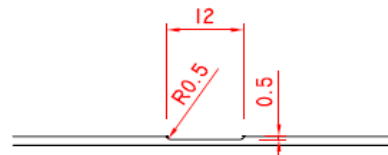

Type 20 (12 x 2,2 mm) - (12 x 1,5 mm)
HDF and HPL

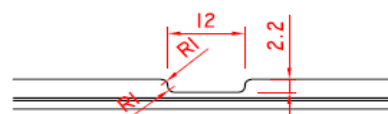

Type 45 (3 x 1,5 mm)
HDF, HPL and 4 layers of veneer

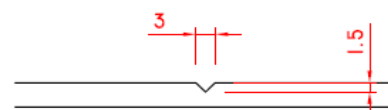

Type 60 (6 x 0,5 mm)
Aluminium

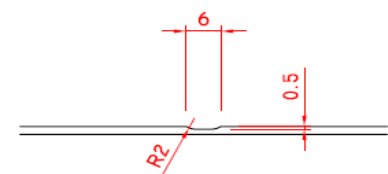

Type 70 (6 x 1,5 mm)
HDF and HPL

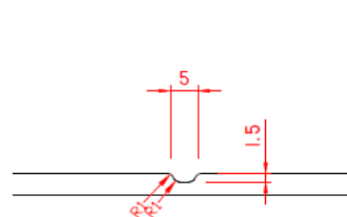

When O.H. Industri makes groove-patterns in Oak and Mahogany veneer, only front veneer and the third layer is Oak and Mahogany which means that there will be a visible lighter line in the second layer. Note that the same type of veneer in all three layers is an option but only on special request and at additional cost.

Please note that the drawing show the different types of grooves only - the construction of the boards may differ.

O.H.Industri A/S
Smedevej 17
DK - 7430 Ikast
+45 9725 1200
www.oh-industri.com

Made: 12.03.2014	Data sheet: PMN	Draw.: HMN
Revised: 01.09.2017	Data sheet: CRS	Draw.: CRS